



## Back-lit LED FLAT PANEL



## PRODUCT DESCRIPTION

The Back-lit LED flat panel is designed for standard T-bar and narrow grid drop ceiling to replace the fluorescent troffer in offices, supermarkets, schools and other indoor applications. The back-lit, slim and low profile design enables superior uniformity.

## FEATURE

1. Emergency battery back-up optional
2. Low-profile and back-lit design
3. Excellent color consistency and CRI

## ELECTRICAL SYSTEM

- Input voltage: 120-347V
- 50/60Hz
- Power Factor: >0.9
- Total Harmonic Distortion: <20% at full load  
Working Temperature: -20~40°C (-4~104°F)

## PERFORMANCE

CRI

80

CCT

3500K- 4000K

Dimming

0-10V Dimming Standard

Projected Lifetime

L70 -129,000 Hours

Working Temperature

-4-104°F (-20-40°C)

Certifications

- cULus conforms to UL Std. 1598Cert. to CSA Std. C22.2 No.250.0
- Suitable for dry locations
- Type IC Rated, suitable for insulated ceilings
- RoHS compliant

## SPECIFICATION

### 2X2

Length: 23.74"

Width: 23.74"

Height: 1.61"

Max. Weight: 4.85 lbs

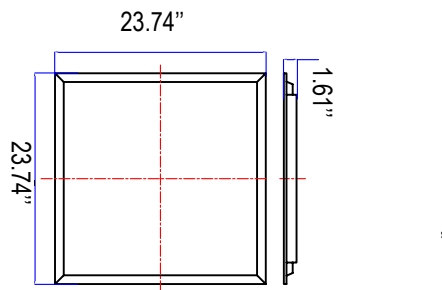

### 2X4

Length: 47.76"

Width: 23.74"

Height: 1.61"

Max. Weight: 9.57 lbs

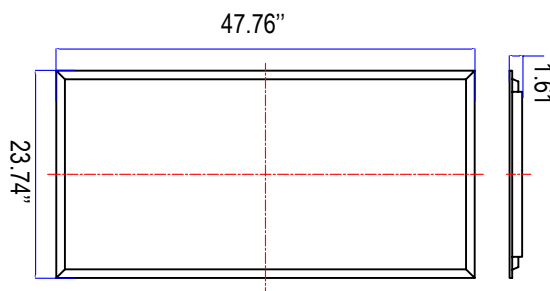

## Ordering Information

Example: BFLP22D40358

Name	Dimension	Dimmable	Watts	CCT	Voltage	Control
BFLP	22 - 2x2'	D - 1-10V dimming	40 - 40W	35 - 3500K	8- 120-347V	Blank - None
	40 - 4000K					
	24 - 2x4'		48 - 48W			

Notice:

\* Standard Finish as White. Special Order as other finish color - Ask Customer Service for Details.

## Accessories (Ordered separately)



**90123**

FLP 2\*4 Surface Mount Kit

**90106**

FLP 2\*2 Surface Mount Kit



**90140**

FLP 2\*4 Flange Kit

**90141**

FLP 2\*2 Flange Kit

## PHOTOMETRY

All published luminaire photometric testing performed to IESNA LM-79-08 standards by a NVLAP certified laboratory.

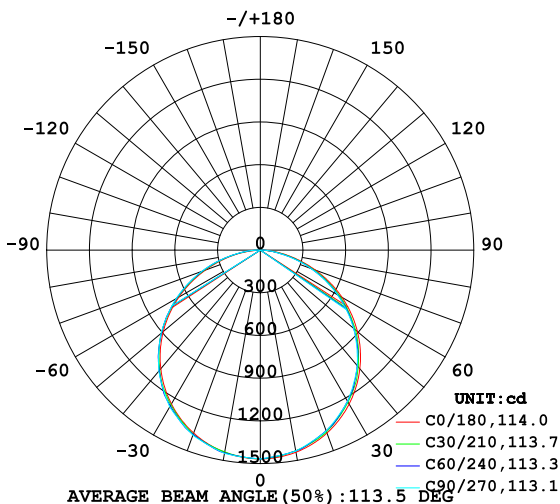

## PERFORMANCE DATA

### LUMEN OUTPUT

Lumen values are measured by third party certified laboratories performed in accordance with IESNA LM-79-08 as well as Lighting Facts listed.

Watts	Lumen Output	AC Input 120V	Measured Watts	CCT	CRI	Size	LPW
40W	4400	0.33A	40W	3500K	>80	2x2	<b>110</b>
48W	5300	0.49A	48W	3500K	>80	2x4	<b>110</b>

#### Lumen Ambient Temperature (LAT) Multipliers

Use these factors to determine relative lumen output for average ambient temperature from -4-104°F (-20-40°C)

Ambient		Multiplier
Celsius	Fahrenheit	
0	32	1.02
10	50	1.01
20	68	1.00
25	77	1.00
30	86	1.00
40	104	0.99

#### Projected LED Lumen Maintenance

Data references the extrapolated performance projections for the LED Flat Panel in a 77°F ambient, (tested per IESNA LM-80-08 and projected per IESNA TM-21-11).

Operating Hours	0	8,000	16,000	31,000	129,000
Lumen Maintenance Factor	1.0	0.98(L98)	0.96(L96)	0.92(L92)	0.70(L70)

## Warranty

Five year limited warranty. Full warranty terms located at [www.abovealllighting.com/warrantystatements](http://www.abovealllighting.com/warrantystatements)

## Note:

Specifications subject to change without notice.