



ECO VISION LED STRIP

Wide size ideal to replace the two-lamp fluorescent strip

PRODUCT DESCRIPTION

ABOVE ALL lighting's ECO VISION STRIP has a sleek design with a diffuser lens. 135LPW with high efficiency performance and a wide lumen range from 2,700lm to 11,000lm, the ECO VISION STRIP comes in standard lengths of 4ft and 8ft. Built-in sensor is available. Optional accessories include reflector, wire guard, V-hook and quick surface mount kits. It can be widely used in stairwells, warehouses, offices, garages, shop displays, and other commercial applications.



FEATURE

- 8% up-light and no glare
- Quick and Easy to wire and install
- Seamless connection
- Built-in sensor
- EBU backup available
- Ceiling & wall surface mounted, suspension mounted

ELECTRICAL SYSTEM

- Input Voltage: 120-347V 50/60Hz
- Class 2 driver
- Minimum Ambient -20°C, Maximum Ambient is 40°C
- Power Factor: > 0.9 at full load
- Total Harmonic Distortion: < 20% at full load

PERFORMANCE

CRI

80

CCT

3000K, 3500K, 4000K

Dimming

0-10V Dimming Standard

Projected Lifetime

L70 - 156,000 Hours

Working Temperature

-4-104°F (-20-40°C)

* Maximum temperature is 95°F (35°C) for 4ft, 90W

Certifications

- cETLus conforms to UL Std. 1598
Cert. to CSA Std. C22.2 No.250.0
- Suitable for damp locations
- IK10 rated
- RoHs compliant

SPECIFICATION

2FT

Net. Weight: 4.5 lbs

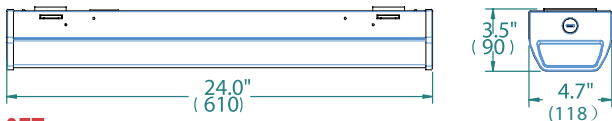

3FT

Net. Weight: 5.9 lbs

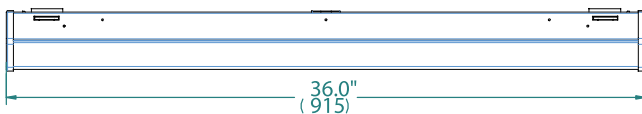

4FT

Net. Weight: 7.5 lbs

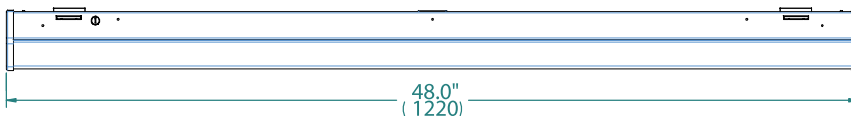

8FT

Net. Weight: 13.5 lbs

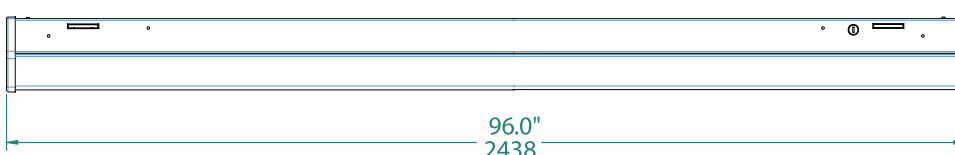

With Two Reflectors

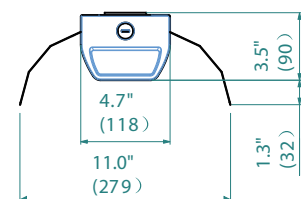

Ordering Information

Example: STR12D30LED408F-SE

Strip	Dimension	Dimmable	Watts	LED	CCT	Voltage	Lens	Controls	Series	
STR	06 - 2FT	D - 0-10V	20 - 20 Watts	LED	30 - 3000K	8 - 120-347V	F-Frosted lens ³	Blank - None	SE - ECO	
	09 - 3FT ⁴	Dimmable	26 - 30 Watts		35 - 3500K		C-Clear Lens ³			MSW-Microwave Dimming sensor ¹
	12 - 4FT		20 - 20 Watts		40 - 4000K		EBU - Emergency Battery Back-up ²			
			30 - 30 Watts							
		45 - 45 Watts								
	24 - 8FT	60 - 60 Watts ⁵								
90 - 90 Watts ⁵										
60 - 60 Watts										
			85 - 80 Watts							

- Microwave dimming sensor for mounting height 20ft (6m) max. Dimming default setting is Bi-Level dim, 50% on vacancy and 100% on Occupancy. Daylight sensor default set to disabled. Other dimming levels such as 20% or 30%, ON/OFF function and daylight sensor can be set by the remote controller MH10.
- Emergency battery back-up is not available for 4ft @ 60W and 90W. It is for ambient temperatures of 32°F-95°F(0°C-35°C). The emergency test button is pre-installed on the fixture. The standard emergency test button is plastic. Metal emergency test button is optional. The EBU is Title 20 compliant. Emergency battery backup is available in 8W with 1360lm and works for a minimum of ninety (90) minutes.
- Frosted lens is standard. Please contact Customer Service for the lead time of clear lens.
- 3ft is without DLC. Please contact Customer Service for lead time of 3ft vision strip.
- 4ft @ 60W and 90W are not available for Emergency Battery Back-up.

* Surface mount is standard. If quick surface mount or V-hook mount is needed, please order the mounting brackets separately. Please check the accessory table for details.

* MSW can read vibration as movement and trigger the sensor despite no physical movement in the sensor field. As such, MSW should not be installed in rooms that experience significant levels of vibration.

* Standard Finish is White. Custom colors might be available for an additional fee. Please check with Customer Service for more information.

Accessories (Ordered separately)

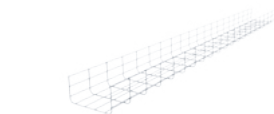

90237

STRP06-WG

Wire guard for 2ft strip



90238

STRP12-WG¹

Wire guard for 4ft and 8ft strip



90264

STRP-QSMK³

Quick surface mount kit for ceiling and wall mount (a pair)



90243

STRP-VH⁴

V-hooks for strip



STR-PMK

Pendant Mount Kits for strip (a pair)

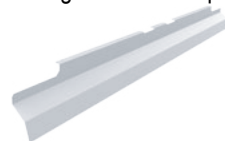

90240

STRP06-RF

Reflector 2ft strip

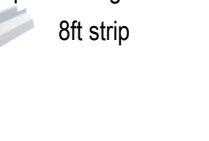

90242

STRP12-RF²

Reflector 4ft and 8ft strip



BMS-L104-B1-PIR-1-BLE-KL-SMO

Passive Infrared (PIR) Bluetooth Sensor



90576

MH10

Remote control for MSW

Accessories (Ordered separately)

Notes:

1. If for 8ft please order two pieces.
2. If this reflector will be installed at one side, then one piece for 4ft and two pieces for 8ft. If this reflector will be installed at both two sides, then two pieces for 4ft and four pieces for 8ft
3. Soft chain mount with V-hooks is the best choice if fixture is with MSW and needed to be installed on a ceiling of long time vibration.

PERFORMANCE DATA

LUMEN OUTPUT

Lumen values are estimated with LED data sheet.

Frosted Lens

Watts	Lumen Output	Size	CRI	AC Input 120V	CCT	LPW
20	2700	2FT/4FT	80	0.27A	4000K	135
30	4050	3FT/4FT	80	0.31A	4000K	135
45	6080	4FT	80	0.39A	4000K	135
60	7800	4FT	80	0.52A	4000K	130
90	11700	4FT	80	0.75A	4000K	130
60	8100	8FT	80	0.52A	4000K	135
80	10800	8FT	80	0.67A	4000K	135

Clear Lens

Watts	Lumen Output	Size	CRI	AC Input 120V	CCT	LPW
20	2840	2FT/4FT	80	0.27A	4000K	142
30	4260	3FT/4FT	80	0.31A	4000K	142
45	6390	4FT	80	0.39A	4000K	142
60	8200	4FT	80	0.52A	4000K	137
90	12300	4FT	80	0.75A	4000K	137
60	8520	8FT	80	0.52A	4000K	142
80	11360	8FT	80	0.67A	4000K	142

Note: 0.97 multiplier for is 3500K.

PHOTOMETRY

All published luminaire photometric testing performed to IESNA LM-79-08 standards by a NVLAP certified laboratory.

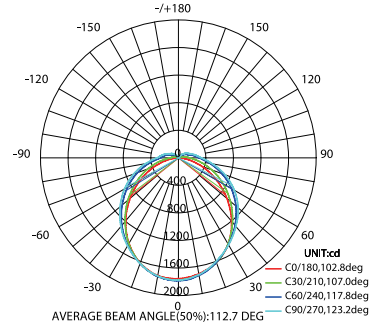

Lumen Ambient Temperature (LAT) Multipliers

Use these factors to determine relative lumen output for average ambient temperature from -4-104°F (-20-40°C)

Ambient		Multiplier
Celsius	Fahrenheit	
0	32	1.06
10	50	1.03
20	68	1.01
25	77	1.00
30	86	0.99
40	104	0.97

Projected LED Lumen Maintenance

Data references the extrapolated performance projections for the LED strip in a 77°F ambient, (tested per IESNA LM-80-08 and projected per IESNA TM-21-11).

Operating Hours	10,000	19,000	38,000	156,000
Lumen Maintenance Factor	0.98(L98)	0.96(L96)	0.92(L92)	0.70(L70)

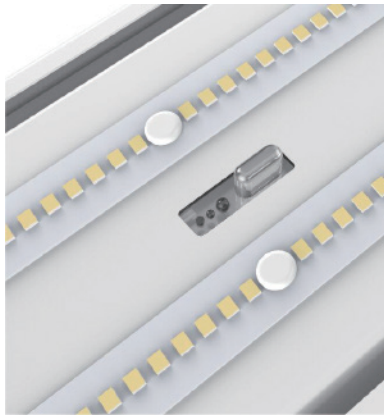

- **Built-in** sensor



- **EBU** backup available
The standard emergency test button is plastic.
Metal emergency test button is optional

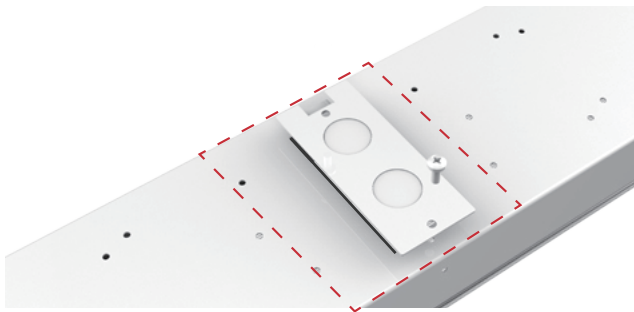

- **Easy to wire**
back side wire entry

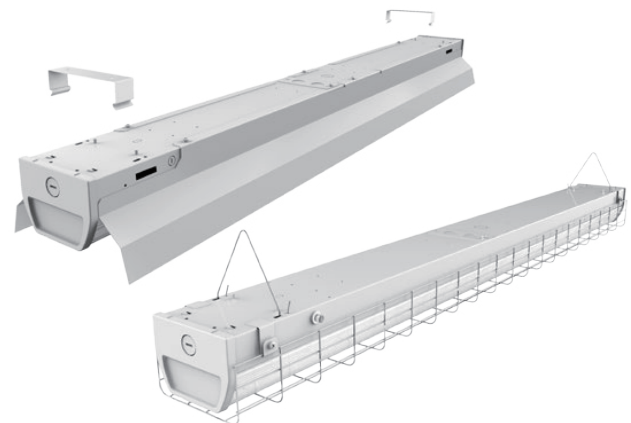

- **Easy to install** quick ceiling & wall surface mount and V-hook mount optional, no need to open the housing.

MICROWAVE DIMMING SENSOR

The sensor is an innovative motion sensor, switch on the light on detection of movement, and switch off after a hold time when there is no motion detected.

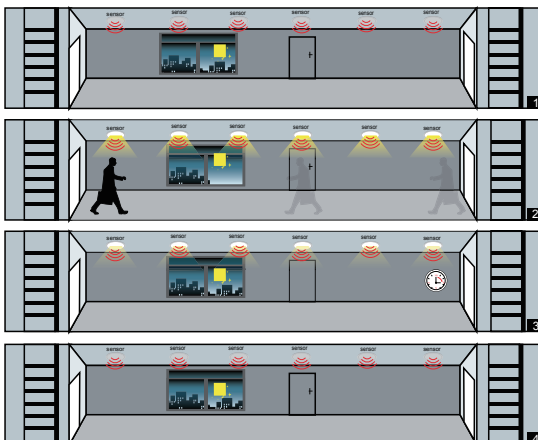

1. No motion detected, all lamps switch off.
2. Any movement is detected from any direction, all lamps synchronously switch on.
3. No motion is detected in detection area, all lamps synchronously dim to a low light level after hold time.
4. After stand-by period, the lamps switch off if no movement is detected in the detection zone.

MICROWAVE DIMMING SENSOR SETTING

Sensor data can be precisely set for each specific application by a remote controller which need to be bought separately.

Detection area

Detection area can be reduced by selecting the combination on the remote controller to fit precisely each application.

Optional Setting: 100%/75%/50%/25%

Default Setting: 100%

Hold time

Refers to the time period the lamp remains at 100% illumination after no motion detected.

Optional Setting: 5S/30S/1min/3min/5min/10min/20min/30min

Default Setting: 20min

Stand-by period

Refers to the time period the lamp remains at a low light level before it completely switches off in the long absence of people. When set to “+∞” mode, the low light is maintained until motion is detected.

Optional Setting: 0S/10S/1min/3min/5min/10min/30min/+∞

Default Setting: +∞

Notes: If just need ON/OFF function, please set the stand-by period in “0S” mode by the remote controller.

Daylight sensor

The sensor can be set to only allow the lamp to illuminate below a defined ambient brightness threshold. When set to Disable mode, the daylight sensor will switch on the lamp when motion is detected regardless of ambient light level. 50lux, 30lux: twilight operation, 10lux, 5lux: darkness operation only. Note that daylight sensor is active only when lamp totally switches off.

Optional Setting: 5lux/15lux/30lux/50lux/100lux/150lux/Disable

Default Setting: Disable

Stand-by dimming level

The low light level you would like to have after the hold time in the long absence of people.

Optional Setting: 10%/20%/30%/50%

Default Setting: 50%

BLUETOOTH PIR MOTION SENSOR

Model No.	Description
BMS-L104-B1-PIR-1-BLE-KL-SMO	Passive Infrared (PIR) Bluetooth Sensor
LS03-HB1-2-WH	HB1 High Bay Lens
LS03-HB3-2-WH	HB3 High Bay Lens

Bluetooth Mesh Control

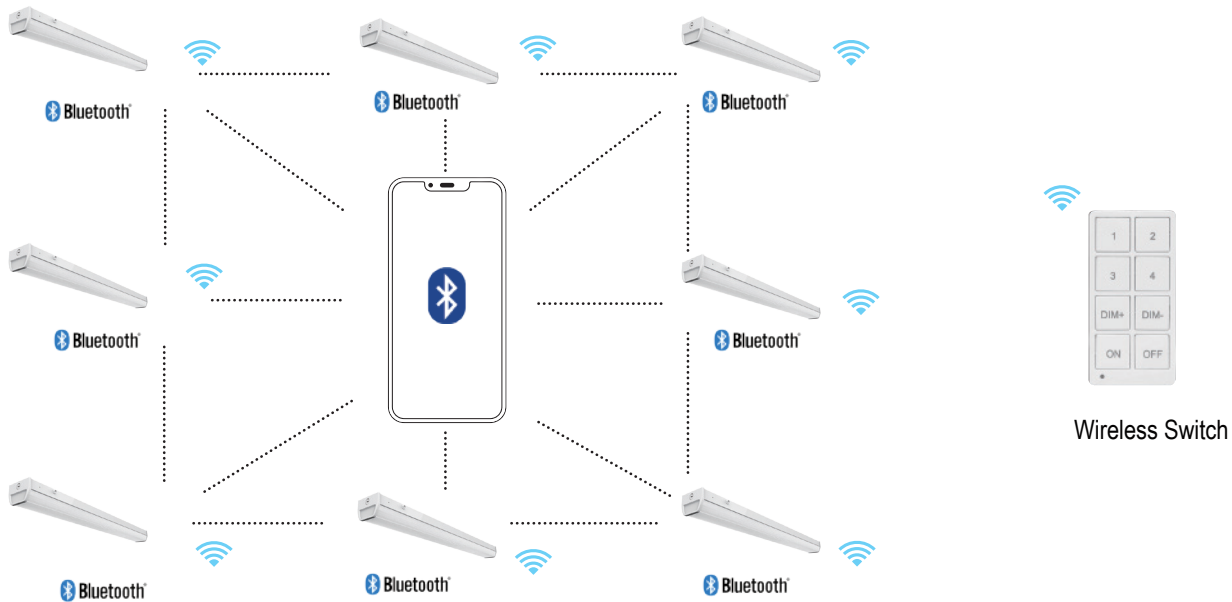

Wireless Switch Options



BMWS-L-D-1-3BT-BLE-KL-WH



BMWS-L-D-5BT-BLE-KL-WH



BMWS-L-D-1-7BT-BLE-KL-WH



BMWS-L-D-8BT-BLE-KL-WH



Detection Area

Unit:inch/mm

HB1 High Bay Lens

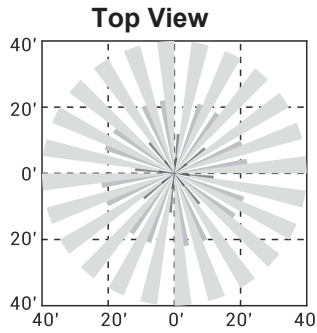
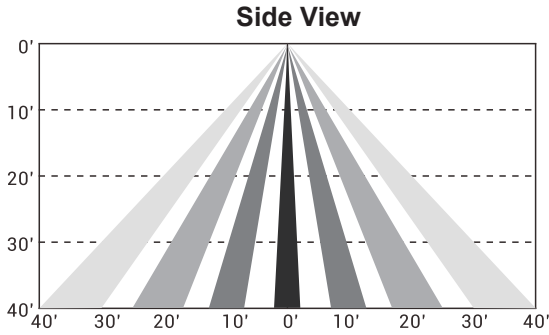

Height 40ft

HB3 High Bay Lens

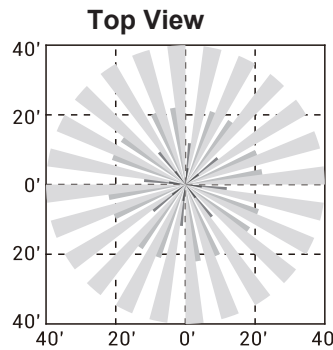
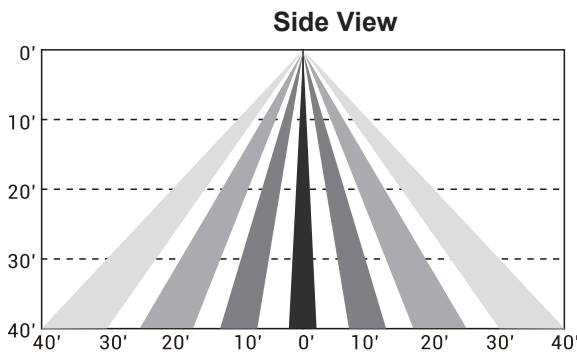

Height 40ft

DETECTING SPOTS FOR REF

ABOVE ALL LIGHTING APP Download

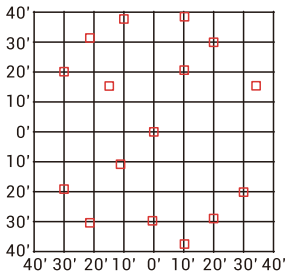

HB1 Lens

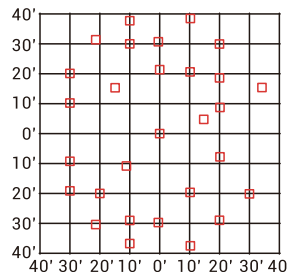

HB3 Lens
(more detected points)



Warranty

Five year limited warranty. Full warranty terms located at www.abovealllighting.com/warrantystatements

Note: Please refers to the instruction manual for motion sensor default setting.