

SUITABLE FOR MODEL



SAFETY INSTRUCTION 

READ CAREFULLY BEFORE INSTALLING FIXTURE. PLEASE KEEP THIS MANUAL FOR FUTURE USE.
Fixtures must be wired in accordance with the National Electrical Code and all applicable local codes. Proper grounding is required for safety.

THIS PRODUCT MUST BE INSTALLED IN ACCORDANCE WITH THE APPLICATION CODE BY A PERSON FAMILIAR WITH THE CONSTRUCTION AND OPERATION OF THE PRODUCT AND THE HAZARDS INVOLVED. MAKE CERTAIN POWER IS OFF BEFORE INSTALLING OR MAINTAINING FIXTURE. CHECK THAT VOLTAGE IS COMPATIBLE WITH FIXTURE DRIVER. USE APPROVED CONNECTORS FOR ALL ELECTRICAL CONNECTIONS.

MAINTENANCE CAUTION 

1. Review the wire connection before beginning, and make sure fixture is grounded properly.
2. For lighting controls, follow control instructions carefully.
3. Turn power off and wait for fixture to cool before performing maintenance.
4. Maintenance must be done by professionals.

WIRE CONNECTION

Universal voltage driver permits operation at 120VAC thru 277VAC, 50 or 60 Hz.

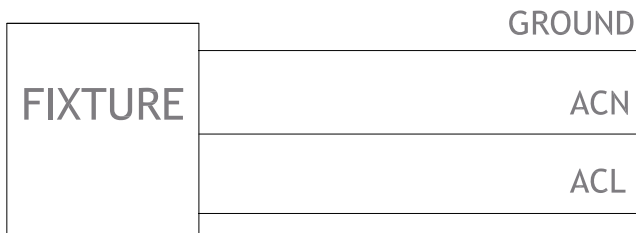

INSTALLATION

ACCESSORY PACK



WIRE NUT X 3

WARNING

- 1. Risk of injury or damage. Make certain power is OFF before installing or maintaining fixture.**
- 2. If fixture is furnished with photocell receptacle, install the photocell or shorting cap.**

SLIP FITTER MOUNT

1. Feed Fixture Wires through Slip Fitter.
2. Secure the Slip Fitter to the Fixture by two Hexagon Socket Screws. Adjust the angle before fixing the screws.
3. Make wire connection with supplied wire nuts and make waterproof treatment by others per "Electrical Connections".
4. Slip the fixture onto a Horizontal or Vertical Pole with diameter of 2 3/8". Make sure all wires are pushed into the pole.
5. Tighten all (6) set screws.

Horizontal Slip Fitter Mount

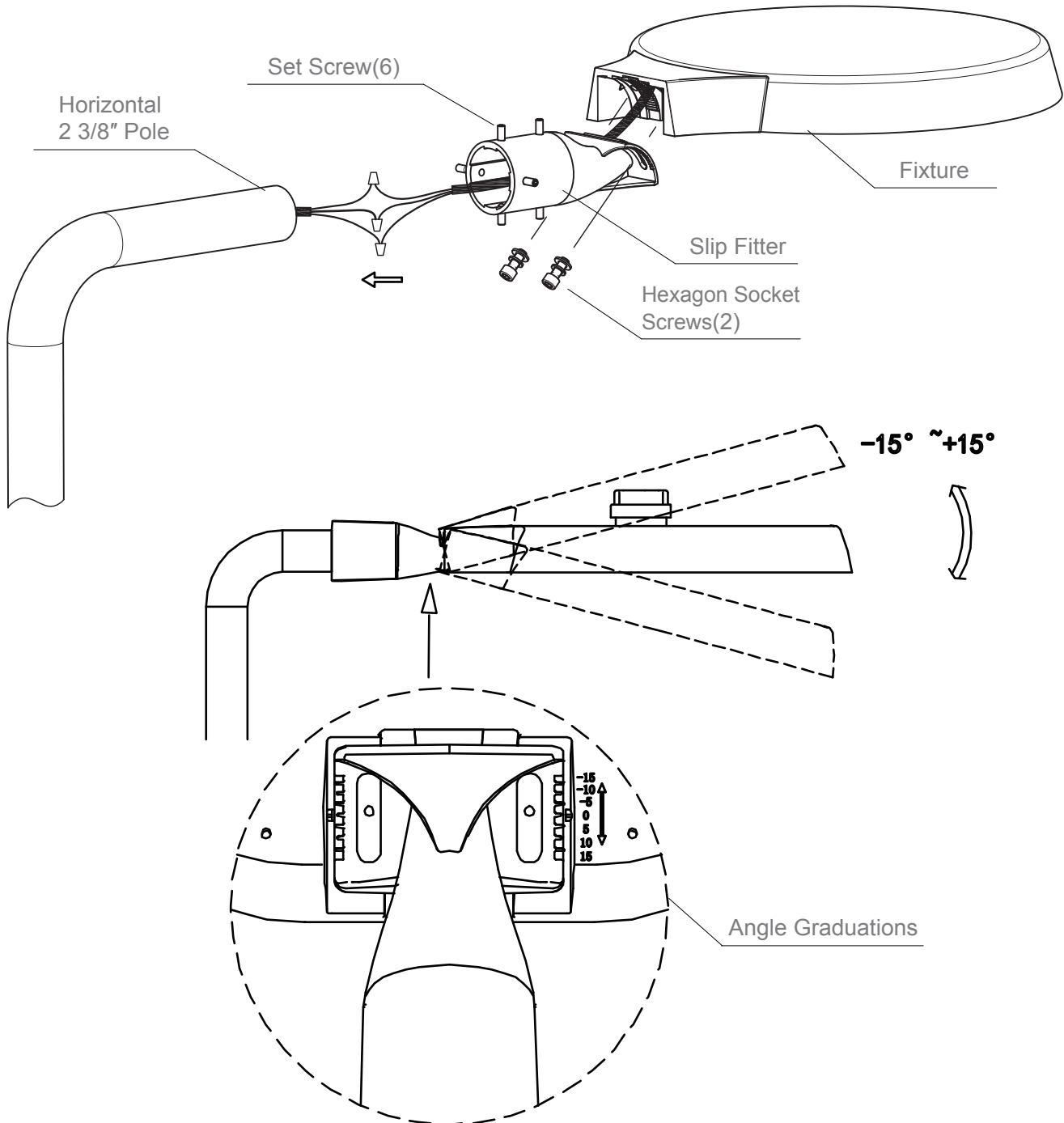

Vertical Slip Fitter Mount

