

LED CENTER BASKET TROFFER



PRODUCT DESCRIPTION

The LED Center Basket Troffer is designed to replace the traditional 2x2 and 2x4 fluorescent troffer. It is suitable for office, super market, and hotel interior decoration. Modern design with high efficiency, high color rendering index and long life span.

ELECTRICAL SYSTEM

- Input Voltage: 120-277V
- 50/60Hz
- 1-10V Dimmable
- Minimum Ambient -4°F, maximum 104°F
- Power Factor: > 0.98 at 120V
- Total Harmonic Distortion: < 20% at 120V

PERFORMANCE

CRI

80

CCT

3500K, 4000K

Dimming

1-10V Dimming Standard

Projected Lifetime

L70 - 106,000 Hours

Working Temperature

-4-104°F (-20-40°C)

Certifications

- cETL listed
- Suitable for damp locations
- DLC premium
- RoHS compliant

SPECIFICATION

2x2

Max. Weight: 8.66lbs

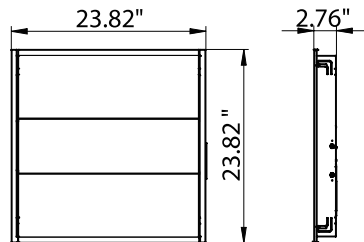

2x4

Max. Weight: 14.04lbs

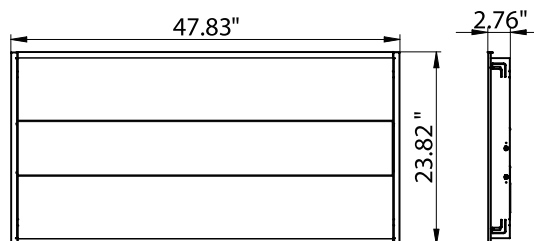

Ordering Information

Example: TR22D35LED35-SP

Center Basket Troffer	Size	Dimmable	Watts	LED	CCT	Series	Control
TR	22-2x2 FT	D - 1-10V	25-25 Watts	LED	35 - 3500K	SP-SP	Blank-None
		Dimmable	35-35 Watts				
	24-2x4 FT	25-25 Watts					
			35-35 Watts		40 - 4000K	series	EBU-Emergency Battery Backup ¹
			45-45 Watts				

Notice:

- Emergency battery backup working temperature is 32-104°F. The emergency test button is pre-installed on fixture. If need a remote test switch please contact factory. The EBU is Title 20 compliant.
- Standard Finish is White.
- Special Order as other finish color - Ask Customer Service for Details.

Accessories (Ordered separately)

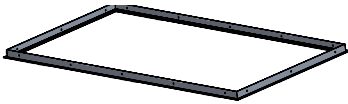

90140

2*4 Flange Kit

2*4 Recessed Mount Kit

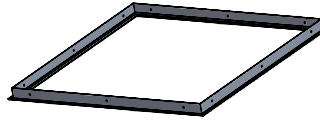

90141

2*2 Flange Kit

2*2 Recessed Mount Kit

Note: The height of our TR fixture is 2.76". Customer need to make sure their ceiling height is high enough.

PHOTOMETRY

All published luminaire photometric testing performed to IESNA LM-79-08 standards by a NVLAP certified laboratory.

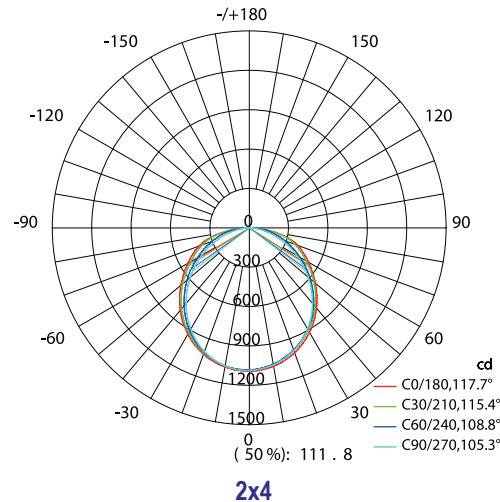
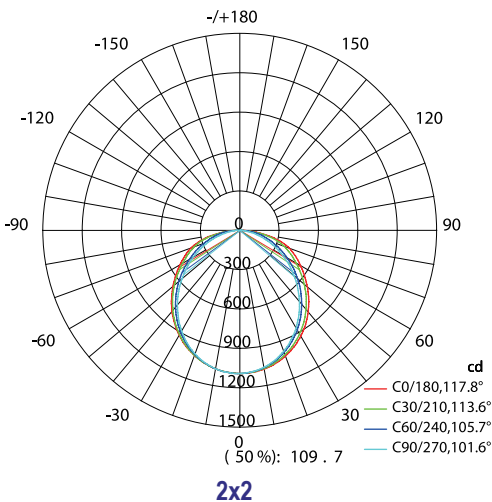

PERFORMANCE DATA

LUMEN OUTPUT

Lumen values are measured by third party certified laboratories performed in accordance with IESNA LM-79-08 as well as Lighting Facts listed.

Watts	Lumen Output	Size	Measured Watts	CRI	CCT	LPW
25W	3225	2X2	25W	>80	5000K	129
35W	4250	2X2	34W	>80	3500K	125
25W	3225	2X4	25W	>80	5000K	129
35W	4250	2X4	34W	>80	3500K	125
45W	5418	2X4	43W	>80	3500K	126

Warranty

Five year limited warranty. Full warranty terms located at www.abovealllighting.com/warrantystatements

Note:

Specifications subject to change without notice.